



Product appearance depends on goods

Wired Controller Manual

Mode Name: XKRA1

Thank you for choosing Polaris Brand Air Conditioners, please read this owner's manual carefully before operation and retain it for future reference.

Content

User Instructions.....	1
Installation and Disassembly.....	1
Installation Place and Installation Requirements.....	1
Installation of the Signal Wire.....	1
Installation of Wired Controller.....	2
Disassembly the Wired Controller.....	3
Display and Installation instruction.....	4
Liquid crystal display.....	4
Bottoms.....	5
Operation Instruction.....	6
Lock Function.....	6
The Switch of Centigrade and Fahrenheit.....	6
Checking the Temp. of Temp. Sensor.....	6
Defrost Function.....	6
On/Off.....	6
Mode Setting.....	6
Temperature Setting.....	7
Fan Speed Setting.....	7
Swing Setting.....	7
Timer Setting.....	8
Turbo Function Setting.....	9
Sleep Function Setting.....	9
Quiet Function Setting.....	10
Clean Function Setting.....	10
ECO Function Setting.....	11
Error Code.....	12



This marking indicates that this product should not be disposed with other household wastes throughout the EU. To prevent possible harm to the environment or human health from uncontrolled waste disposal, recycle it responsibly to promote the sustainable reuse of material resources. To return your used device, please use the return and collection systems or contact the retailer where the product was purchased. They can take this product for environmental safe recycling.

User Instructions

Please carefully read this manual before installation and use of this product.

- Do not install or remove the wired controller by yourself. If necessary, please contact the after-sales serviceman.
- Do not install the wired controller in the humid area or under direct sunlight.
- Do not beat, toss, or frequently assemble/disassemble the wired controller.
- Do not operate the wired controller with wet hands.
- This wired controller is applicable to various kinds of air conditioners, while some specific functions unavailable to the duct type air conditioners will not be covered in this manual.

Installation and Disassembly

1. Installation Place and Installation Requirements

- Do not install the wired controller in the humid area or under direct sunlight
- Do not install the wired controller close to the high-temperature object or place where is easy to splash on the wired controller.
- Do not install the wired controller directly opposite to the window so as to avoid improper operation caused by the interference of the neighbor's same model wired controller.
- Please cut off the power supply of wires embedded in the wall. No operation is allowed with electricity.
- To avoid abnormal operation caused by electromagnetic interference or other causes, please take notice of the following statements during wiring.
 1. Be sure the communication line is wired into the correct port, otherwise it would lead to communication fault.
 2. The communication line (wired controller) and power line must be separated with the minimal distance of 20cm, otherwise it would lead to communication fault.
 3. If the air conditioner is installed where is easy to suffer electromagnetic interference, the communication line of the wired controller must be shielded twisted pair.

2. Installation of the Signal Wire

1. Open the indoor unit electric box cover.
2. Make the signal line go through the rubber band
3. Insert the signal wire port in the 4-seat needle which on the indoor unit circuit board.
4. Tightly fix the signal wire with wire ties.

Notice:

The communication distance between main board and wired controller can reach 20m.
(The recommended length is 8m)

Installation and Disassembly

3. Installation of Wired Controller

The simple installation step of wired controller is as shown on the figure, please notice below issues:

- Open the bottom plate of the wired controller.
- Pull out the 4 core twisted pair wire from the mounting hole and pass this line through the square hole located at the bottom plate of the wired controller.
Use M4×25 screws to fix the bottom plate together with installation hole of the wall.
- Insert the through signal wire in the slot on the wired controller, also lock the wired controller panel and bottom plate together.

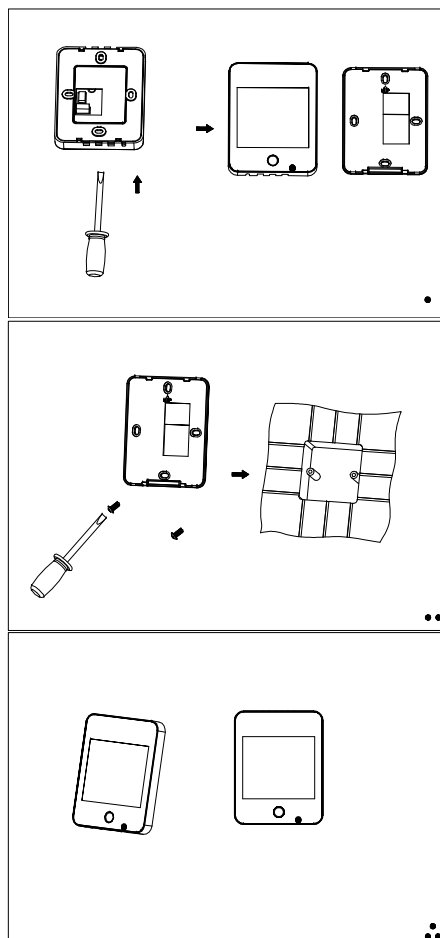

Display and Installation instruction

Liquid crystal display:

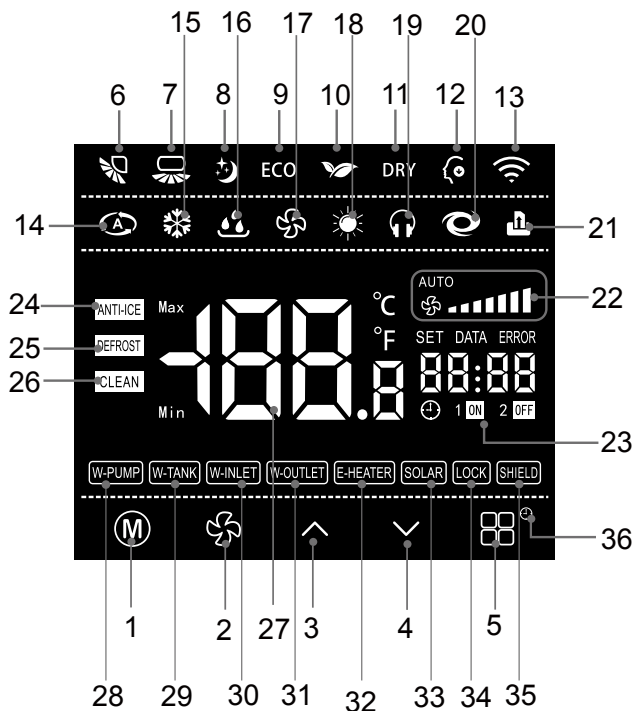

NO.	Icon Name	Icon Instruction
1	Mode	Select the operating mode:Auto,Cooling,Dehumidification,Fan,Heating
2	Fan	Setting fan speed
3	^	Setting operating temp., range:16-31°C (61°F-88°F)
4	v	Setting timer time, range: 0.5-24 hour
5	Function	Select Clean, ECO, Sleep, Turbo, Quiet, etc. functions.

Display and Installation instruction

NO.	Icon Name	Icon Instruction
6	Horizontal Swing	Horizontal Sw ing function status
7	Vertical Swing	Vertical Sw ing function status (N/A)
8	Sleep	Sleep function status
9	ECO	ECO function status
10	Dry	Dry function status
11	Health	Health function status (N/A)
12	Memory	Memory function status
13	Wifi	Wifi function status
14	Auto	Operating in AUTO mode
15	Cooling	Operating in Cooling mode
16	Dehumidification	Operating in Dehumidification mode
17	Fan	Operating in Fan mode
18	Heating	Operating in Heating mode
19	Quiet	Quiet function status
20	Turbo	Turbo function status
21	Access control	Plug-in/out card status
22	Fan speed	Current setting fan speed
23	Timer	Timer status
24	Anti-ice	Anti-ice function status (N/A)
25	Defrost	Defrost function status
26	Clean	Clean function status
27	TEMP.	Ambient temp. / setting temp.
28	W-pump	W-pump status (N/A)
29	W-tank	W-tank status (N/A)
30	W-inlet	W-inlet status (N/A)

Display and Installation instruction

NO.	Icon Name	Icon Instruction
31	W-outlet	W-outlet status (N/A)
32	E-Heater	E-Heater function status
33	Solar	Sloar status (N/A)
34	Lock	Keyboard lock status
35	Shield	Shield status
36	Timer	Setting timer on/off

Bottoms:



No.	Button Name	Button Instruction
1	Home	Turn on/off unit

Operation Instruction

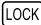

Lock Function

In the on/off-state, press " ^ " and " v " buttons at the same time for 5s till the wired controller enters the lock state. In this case, the LED display "  ". After that, repress these two buttons at the same time for 5s to quit the lock state.

Notice:

In the lock state, if malfunction occur, all the buttons will be shield besides Home button.

The Switch of Centigrade and Fahrenheit

In On/Off-state, press "  " and "  " button for 5s to switch between Centigrade and Fahrenheit.

Defrost Function

In Heating mode, when the condition meets the standard that the outdoor unit control system can turn on the defrost function, the units will defrost automatically, "  " icon appear.

On/Off

Press the "Home" button to turn on or off the unit.

Mode Setting

In on-state, press the "  " button to switch the operation modes as the sequence shown in below:

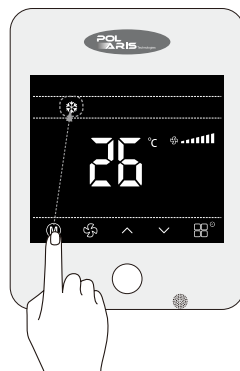

Operation Instruction

Temperature Setting

Press " ^ " or " v " button to increase or decrease setting temperature in on-state of the unit. If press either of them continuously, temperature will be changed rapidly. Temperature setting range is 16°C~31°C (61°F-88°F).

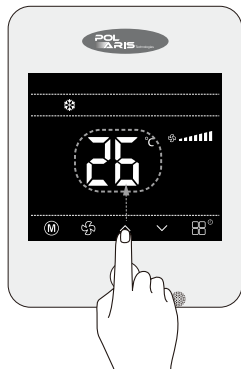

Fan Speed Setting

Press "  " button, fan speed of indoor unit will change as the sequence below:

Fixed Speed Air Conditioner :

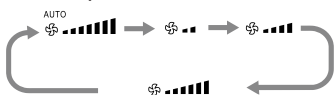

Inverter Air Conditioner :



Notice:

- After installation completed, wired controller will detect the unit type automatically. Different types may have different ways of fan speed display, it can be divided into the 2 kinds above.
- In Dehumidification mode, the fan speed is default to low fan speed and can not be adjusted.
- When set the AUTO mode, the indoor fan speed will be changed according to the indoor ambient temp., the fan speed strip is not displayed.

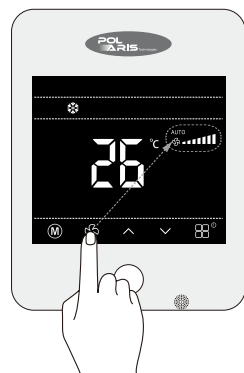

Swing Setting

In on-state, press the: "  " button, the swing function will be adjusted as below sequence:

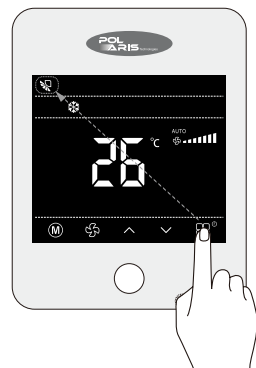
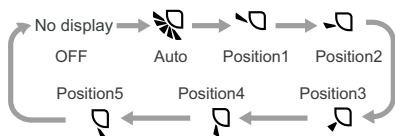

Operation Instruction

Timer Setting

In on-state, press "⏏" button for 3s to set turn off time; in off-state, press "⏏" button for 3s to set turn on time. Timer range: 0.5-24h

Notice: The min gap of time display is 0.5h, less than 0.5h will display 0.5h.

- Timer Setting:

Press "⏏" button, "SET" icon displayed, then press "▲" / "▼" to adjust the time, after that, press the "⏏" button again to make a confirmation ("SET" disappeared), setting complete.

- Cancel Timer Setting:

After Timer is set, press "M" button, "SET" icon and timer time disappear, setting canceled.

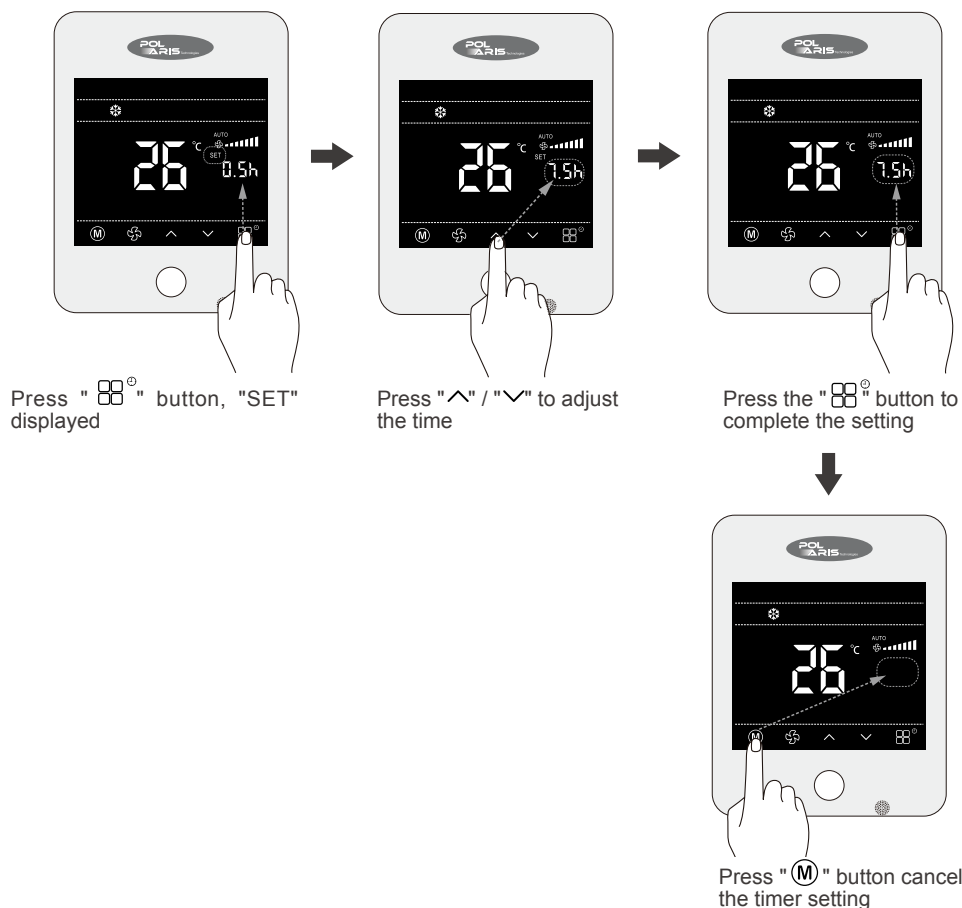

Operation Instruction

Clock Setting

Under the timer setting, press "⏏" button for 8 seconds to turn to the clock setting mode, At present, the "⌚" icon blink, display the system clock, press "M" to select hours and minutes, "▲" or "▼" to adjust the time, long press "▲" or "▼" to increase time rapidly or continuously. Press the "⏏" button again to make a confirmation (press "⌘" or power button to not save and quit), at any time, more than 5S does not operate, does not save and exit, and returns to the original interface.

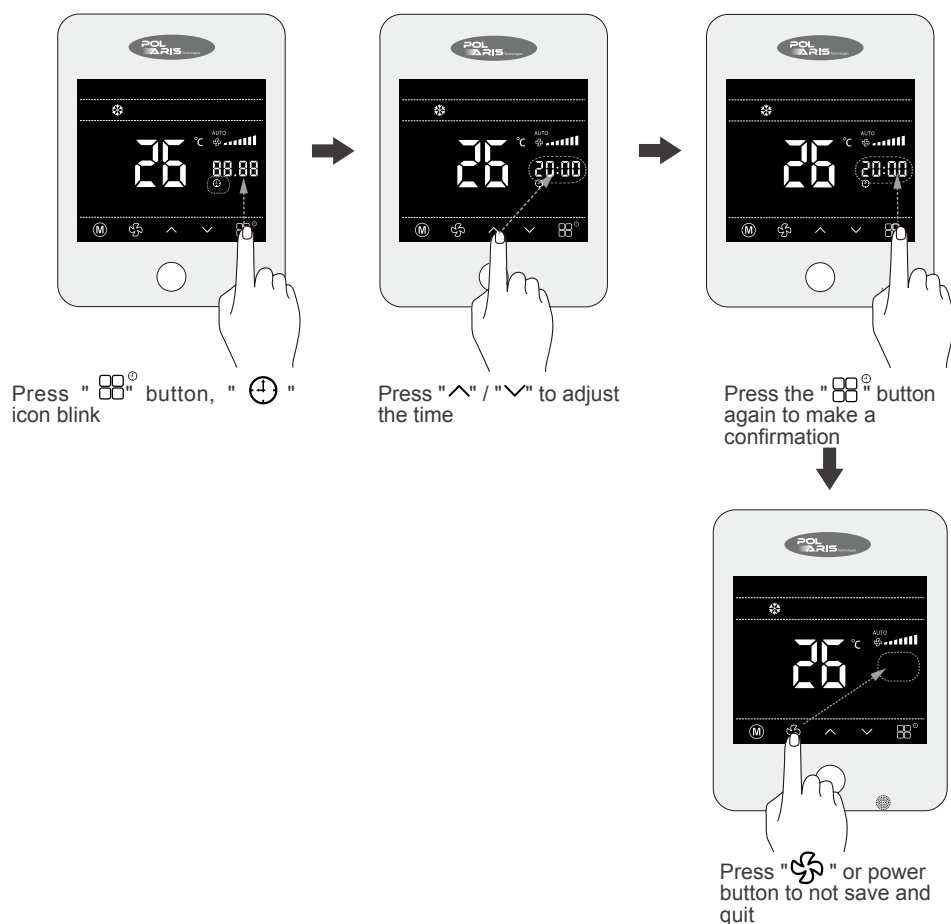

Operation Instruction

Turbo Function Setting

In Cooling/Heating/Fan mode, press "🌀" button for 3s to switch the Turbo function, In this case, the LED display "🌀" and "🔊". After that, press "🌀" button at the same time for 3s to quiet function. then press "🌀" button to turn off the function.

Notice:

- When turn on Turbo function, the fan speed strip will not change.
- Switch to other mode and adjust the fan speed will both exit the Turbo function automatically.
- Can not turn on "Turbo" and "Quiet" function in the same time.
- There has no Turbo function in Dehumidification/Auto mode.



In Cooling/Heating/Fan mode

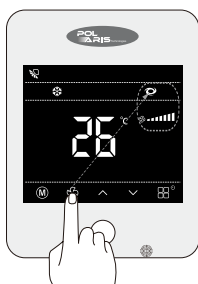

Press "🌀" button switch to the Turbo function

Sleep Function Setting

In Cooling/Heating/Dehumidification mode, press "🔊" button to access the function selection mode, press "⤴" or "⤵" button to switch the Sleep function, "🌙" icon blinking, then press "🔊" button to turn on/off the function.

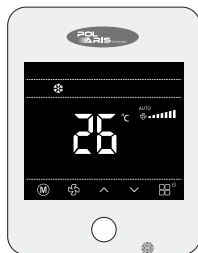

In Cooling/Heating/Dehumidification mode

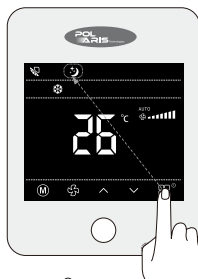





Press "🔊" button switch to the Sleep function, "🌙" icon blinking



Press "🔊" button to turn on/off the function

Operation Instruction

Quiet Function Setting

In Auto/Cooling/Dehumidification/Fan/Heating mode, press "  "button for 3s to switch the Turbo function, After that press "  "button at the same time for 3s to Quiet function, In this case, the LED display "  "and "  ". Then press "  "button to turn off the function.

Notice:

- When turn on Quiet function, the fan speed strip will not change.
- Switch to other mode and adjust the fan speed will both exit the Quiet function automatically.
- Can not turn on "Turbo" and "Quiet" function in the same time.

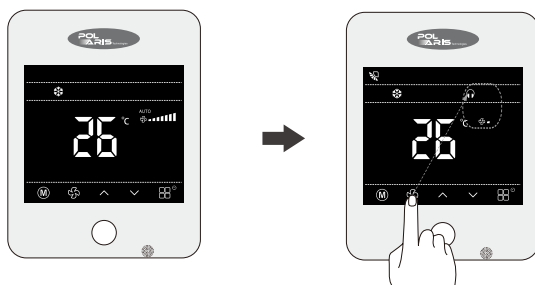







In Auto/Cooling/Dehumidification/
Fan/Heating mode

Press "  " button switch to the
Quiet function

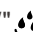
ECO Function Setting

ECO function can make the air conditioner runs in a smaller temperature range by setting limited value of setting temperature in the Cooling or heating mode to achieve energy saving.

In Cooling/Dehumidification/Heating mode, press "  " button to switch to ECO limited temperature setting function, "ECO" and ("  "/"  "/"  ") icon blinking, press "  " / "  " button to set cooling(heating) limited setting temperature, then press "  " button to turn on/off this function.



The initial min. limited cooling setting temperature is 26°C(79°F), the initial heating max. limited heating setting temperature is 22°C(72°F).

Operation Instruction

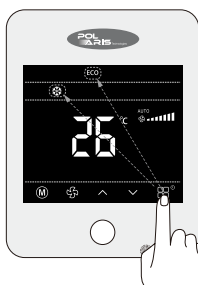

In Cooling/Dehumidification/
Heating mode



Press "  " button to switch to
ECO limited temperature
setting function, " ECO " and ("  "  ") icon blinking

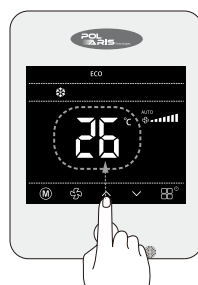

Press "  " / "  " button to
set cooling(heating) limited
setting temperature



Press "  " button to turn
on/off this function

Error Code

When error happens to the unit, the error code will be shown on the wired controller. When multiple errors simultaneously happen, the error codes will circularly show up. When error occurs, please immediately shut down the unit and contact service center.

- If show other code, please turn off and contact the service center.
- If show "bL", please turn off and clean the filter(please cut off power before take out filter).
Finish clean and well install the filter, please turn on , then the code will disappear.

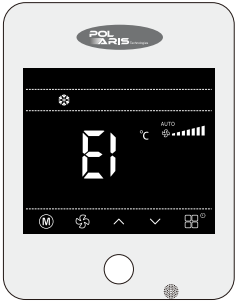

Error Code	Name
bL	Filter clean remind
H0	High exhaust temp. protection
H1	Overcapacity protection
H2	Compressor overload protection
H3	Anti-frost protection
H4	System high pressure protection
H5	System low pressure protection
H6	Lack refrigerant/ valve stop protection
C8	Auxiliary heat adhesion protection
C9	The communication between indoor unit and wired controller fault
E0	Indoor temp. sensor open/short circuit
E2	Outdoor temp. sensor open/short circuit
CJ	Wired controller temp. sensor fault
FF	Defrost or heating oil return
C3	Indoor unit report outdoor unit fault
Cb	Water full protection

